

### Tools Required:

2.5mm hex key  
3mm hex key  
Phillips head screwdriver medium  
Flat head screwdriver

CSA certified to U.S. and Canadian standards.  
Suitable for wet locations.

**Protection class:** IP65

**Weight:** 7.7 lbs.



### Dimensions

A: 10-1/4 "

B: 4-3/4 "



### Notice to Installer for 33 509:

- BEGA luminaires may be damaged if connected to conduit systems containing water- Article 300-5G of National Electric Code requires that "Conduits or raceways through which moisture may contact energized live parts shall be sealed or plugged at either or both ends".**
- Mounts directly to a standard octagonal 4" wiring box (by others) using BEGA mounting kit (supplied).  
NOTE: Recommended that installer uses (2) screws (by others) to lock in place back housing, along with BEGA mounting kit, to wall surface for eased installation. (Fig. 2)
- In conformance with U.L. Standards 1598, a silicone-based sealant **MUST** be used between the mounting plate edge and supporting wall.
- LEDs are high-quality electronic components! Please avoid touching the light output opening of the LED directly during installation.

### 33 509 - Installation:

- Loosen 3mm set screw on luminaire outer trim ring and turn ring to the stop (ccw). Remove trim ring with glass from luminaire base.
- Loosen (2) hex screws on LED module plate and CAREFULLY remove LED module - trying not to come into direct contact with the LED chips.
- Install (2) long 8-32 x 3/4" mounting screws (provided) in the back of the adapter plate as shown (Figure 1).
- Attach adapter plate to wiring box using (2) 8-32 x 1/2" screws provided. Feed luminaire wires through luminaire base and adapter plate.
- Make supply wiring and luminaire wiring connections in the octagonal wiring box:  
MAIN VOLTAGE SUPPLY WIRE TO BLACK LUMINAIRE WIRE  
NEUTRAL (COMMON) SUPPLY WIRE TO WHITE LUMINAIRE WIRE  
WIRE GREEN GROUND WIRE TO GREEN LUMINAIRE WIRE  
Dimming (if applicable):  
DIMMING CONTROL WIRE (+) TO POSITIVE DRIVER DIM CONTROL WIRE  
DIMMING CONTROL WIRE (-) TO NEGATIVE DRIVER DIM CONTROL WIRE
- Place a small bead of silicone around the back side of the luminaire base that will come in contact with the finished wall (exterior applications only).
- Attach luminaire to adaptor plate over the mounting screws using the (2) acorn nuts provided in the mounting kit. Tighten the nuts to back the screws into the wiring box and secure the plate to the box.
- Replace the LED module carefully along with luminaire lens and trim ring. Turn trim ring to the stop (cw) and tighten outer set screw to secure.

Figure 1 (Generic Image)

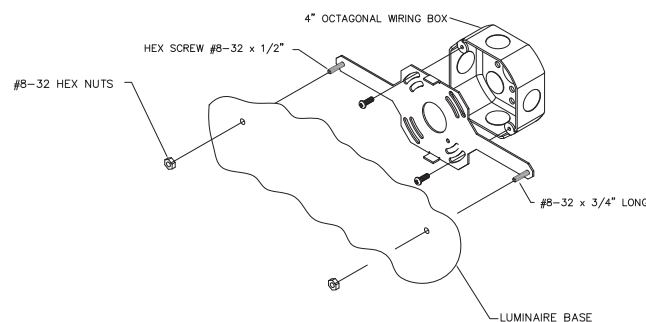
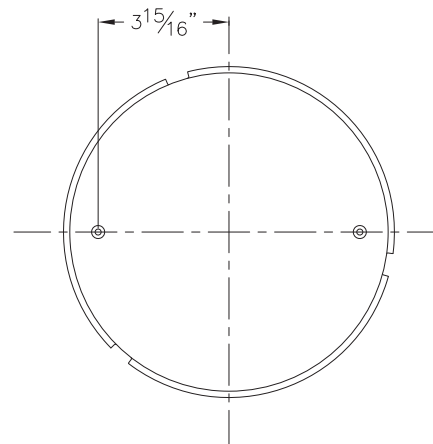

Figure 2: Secondary Wall Mount Screw Holes



### Relamping/Maintenance

No relamping required.

### Accessories

Please refer to the appropriate accessory installation sheet for further instruction when applicable.

### Replacement Parts

Description	Part No
Lens	11297611
Gasket	831382
Driver	75983-01
LED Module (3000K)	LED-0381/930
LED Module (4000K)	LED-0381/940

**Lamp:** 10.5W LED

**Product Safety Warnings:**

**THIS PRODUCT MUST BE INSTALLED IN ACCORDANCE WITH THE APPLICABLE INSTALLATION CODE BY A PERSON FAMILIAR WITH THE CONSTRUCTION AND OPERATION OF THE PRODUCT AND THE HAZARDS INVOLVED. SUITABLE FOR WET LOCATIONS.**

**MIN 90°C SUPPLY CONDUCTORS.**

**CE PRODUIT DOIT ÊTRE INSTALLÉ SELON LE CODE D'INSTALLATION PERTINENT, PAR UNE PERSONNE QUI CONNAÎT BIEN LE PRODUIT ET SON FONCTIONNEMENT AINSI QUE LES RISQUES INHÉRENTS. CONVIENT AUX EMPLACEMENTS MOUILLÉS.**

**LES FILS D'ALIMENTATION 90°C MIN.**

---