

**Tools Required:**

4mm hex key  
13mm socket wrench

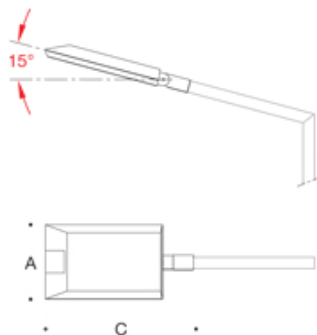

**Dimensions**

**A:** 10"  
**B:** 2-3/8"  
**C:** 19-1/4"



**Protection Class:** IP66

**Weight:** 11.02 lbs.

**Notice to Installer for 99 433:**

1. See page 2 for specific product safety warnings.
2. For side mounted pole applications only.
3. Slip fits **minimum** 1-5/8" tenon poles only.
4. LED module and integral driver provided by BEGA.
5. Pole top luminaire supplied with 25 feet of cable to route through pole.
6. Do NOT remove moisture absorption packet from luminaire housing.

**99 433 - installation:**

1. Lead luminaire wires into pole and through to the base.
2. Secure luminaire head to pole by tightening (x6) 4mm hex screws.
3. To adjust beam direction (up to 15 degrees), undo hex nut and adjust joint. Be sure teeth are secured into position. **BE CAREFUL AS THE FIXTURE WILL DROP QUICKLY UPON LOOSENING.**
4. Make supply wiring and luminaire wiring connections inside pole base:  
MAIN VOLTAGE SUPPLY WIRE TO BLACK LUMINAIRE WIRE  
NEUTRAL (COMMON) SUPPLY WIRE TO WHITE LUMINAIRE WIRE  
GREEN GROUND WIRE TO GREEN LUMINAIRE WIRE

**Dimming (if applicable):**

DIMMING CONTROL WIRE (+) TO POSITIVE LUMINAIRE DIM CONTROL WIRE  
DIMMING CONTROL WIRE (-) TO NEGATIVE LUMINAIRE DIM CONTROL WIRE

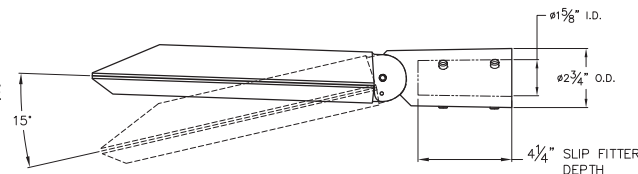
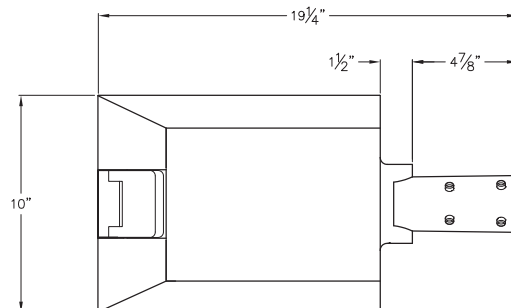

**Relamping/Maintenance**

No relamping necessary.

**Accessories**

Please refer to the appropriate accessory installation sheet for further instruction when applicable.

**Replacement Parts**

Description	Part No
LED Driver	75985-03
LED Module (3000K)	(x2) LED-0282/830
LED Module (4000K)	(x2) LED-0282/840

**Lamp:** 31.4W LED Module

## Product Safety Warnings:

**CAUTION - RISK OF FIRE. THIS PRODUCT MUST BE INSTALLED IN ACCORDANCE WITH THE APPLICABLE INSTALLATION CODE BY A PERSON FAMILIAR WITH THE CONSTRUCTION AND OPERATION OF THE PRODUCT AND THE HAZARDS INVOLVED. SUITABLE FOR WET LOCATIONS.**

**MIN 60°C SUPPLY CONDUCTORS.**

**ATTENTION - RISQUE D'INCENDIE, CE PRODUIT DOIT ÊTRE INSTALLÉ SELON LE CODE D'INSTALLATION PERTINENT, PAR UNE PERSONNE QUI CONNAÎT BIEN LE PRODUIT ET SON FONCTIONNEMENT AINSI QUE LES RISQUES INHÉRENTS. CONVIENT AUX EMPLACEMENTS MOUILLÉS.**

**LES FILS D'ALIMENTATION 60°C MIN.**

---